

Built Environment Industry (BEI) Asia Awards 2013



*Colin Thoms, Chief Executive Officer,
Fast Flow Group (Top Winner) at the
Awards Ceremony and Gala Dinner,
Shangri-La, Singapore*

Fast Flow is humbled to have received the BEI Asia Awards 2013, in the REGIONAL AWARD (Accretion, Diversification, Exceptional Award) category which is testament to what we have accomplished. This award validates Fast Flow's leadership and ability in providing excellence in rainwater management services both locally and overseas. The win affirms the efforts that Fast Flow has made to build the brand and company.

The inaugural BEI Asia Awards, organised by Creative Group Pte Ltd, was launched to recognise, reward and honour the achievements of leading enterprises across Singapore's built environment industry. According to the organisers: "The awards acknowledge both local and locally-based companies, which have demonstrated excellence in establishing successful businesses while engaging in best business practices such as corporate social responsibility through sustainable efforts."

Fast Flow has been featured in a recent article by The Business Times supplement on Tuesday, 10th December 2013 as a company that has leveraged on a regional and international footprint to gain an edge in the market it operates in.



Wishing You A Merry Christmas & A Prosperous New Year

Inside this issue...

BEI Asia Awards 2013
Rainwater Harvesting
Did You Know?

Projects Under The Spotlight
FFRGM2013
Our Presence



Rainwater Harvesting

The harvesting of rainwater simply involves the collection of water from surfaces on which rain falls, and subsequently storing this water for later use. Normally water is collected from the roofs of buildings and stored in rainwater tanks. Nowadays, the application of rainwater harvesting system in buildings has become mandatory in Australia, Malaysia and Canada. While in Singapore, having extensive green features such as self-sustainable landscaping, grey water recycling, rainwater harvesting and the use of renewable energy sources have helped developers to achieve BCA's Green Mark High Scheme's Highest Accolade, the Green Mark Platinum Award.

Rainwater harvesting is one strategy in the greater scheme of reducing domestic water use. Rainwater may be utilised for both potable and non-potable requirements such as drinking, cooking, laundry and landscape irrigation. The application of an appropriate rainwater harvesting technology can make the utilisation of rainwater as a valuable and necessary water resource. By harvesting rainwater, we can be led to dozens of other practices that bring us into greater sustainability.

The National Library in Singapore, Singapore Sports Hub and Ngurah Rai International Airport in Indonesia are just some of Fast Flow's projects that include rainwater harvesting systems in the building's design. Fast Flow's siphonic system allows various outlets to combine into single system and transport water through long distances without a slope, making it the ideal transportation tool for rainwater harvesting. Our psPipe™ & psFittings™ are also LEAD-FREE which minimizes water pollution.



Ngurah Rai International Airport, Bali - Indonesia

Did You Know?

- Water use has increased by 70% since 1970.
- On average, each person flushes the toilet about six times a day, older people flush the toilet more than 6 times a day.
- Toilet flushing is the single largest use of household water, 30-40%, up to 90% for offices.
- Each person uses about 150 litres of water every day. About 60 litres of this is for toilet flushing.
- A leaky tap in the office toilets or canteen kitchen can waste 60 litres an hour (5mm stream) or nearly half your daily usage.
- 38 litres of water are needed to refine 1 litre of petrol.
- Rainwater Harvesting is already common in Europe – around 100,000 systems were installed during 2005/2006.
- Capturing rainwater reduces flooding, erosion, and the contamination of surface water with sediments, fertilizers, and pesticides in rainfall runoff.
- Rainwater is better for plants because it contains more usable nutrients and is free of salts and other minerals that harm root growth.

Source: <http://oasis-rainharvesting.co.uk>

Samarinda Baru Airport

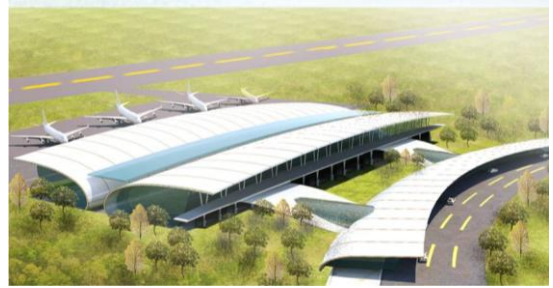
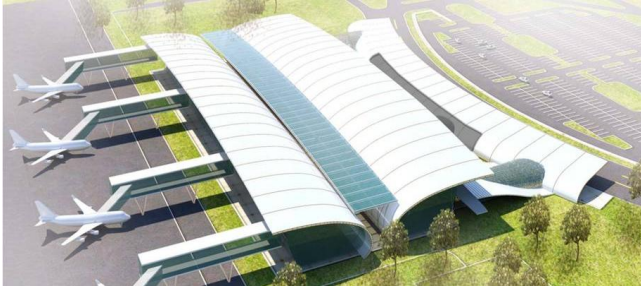

Architect: PT Arkonin | Main Contractor: PT Waskita Karya (Persero) Tbk | Location: Samarinda City, East Kalimantan Province | Total roof area covered by Siphonic System : 9,580,00sqm

Following a competitive interview process Siphonic Flow Mandiri, licensed distributor of Fast Flow in Indonesia, has been appointed by the government of Indonesia to provide rainwater management solution for Bandara Samarinda Baru. Located in the village of Sungai Siring, which is one of the five villages in North Samarinda sub district. Master-planned by PT Arkonin, this development of 4,700,000 square metres gross floor area will be opened in mid of 2014 and aims to serve 5,000,000 passengers per annum.

Garuda Maintenance Facilities (GMF)

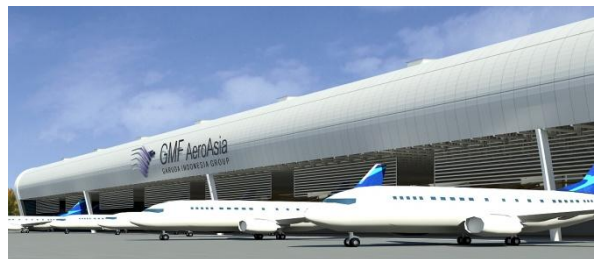
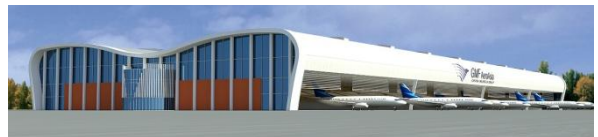
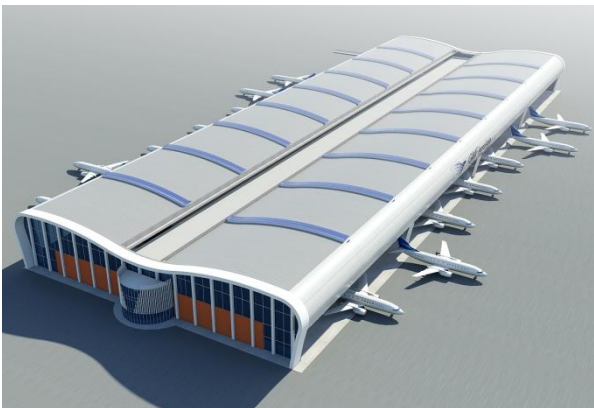

Design & Build: PT. Wijaya Karya (Persero), Tbk | Location: Soekarno-Hatta International Airport Complex, Tangerang City, Banten Province | Total roof area covered by Siphonic System: 56,500.00 sqm

Thanks to a successful marketing drive by Fast Flow's licensed distributor- PT Siphonic Flow Mandiri, Fast Flow has recently secured another project in Indonesia. Located in Soekarno-Hatta International Airport and with a capacity of 16 narrow-body aircraft on a 18,000 square-meter plot of land, this government owned project will be completed by mid 2014.

FFRGM2013: Can we DELIVER what we can SELL?

Fast Flow Regional General Meeting (FFRGM2013) was held in Singapore early in December. This three-day event took place in The Singapore British Club from 9th to 11th December 2013. The purpose of the FFRGM is to gather Fast Flow managers and key staff across Asia Pacific to share current activities already going on in the company and to share vision about future business strategies and how we can become more organized.

Fast Flow's latest pipe project - the LEAD-FREE psPipe™ and psFittings™ and the newly launched psStackH™ System were the highlights of day one event. Continued with Supply Chain and Operational Management on the second day, where selected Fast Flow's key staff received the opportunity to share information on how to meet the needs of our customer in terms of quality and quantity, time and location. Human Resources, Operational Control and Business Compliance were among the topics on the last day of the event.

The FFRGM plays a crucial role in the pursuit of the corporate business vision which includes Fast Flow's Core Values, Fast Flow's Core Purpose and Fast Flow's Business Strategy.





Fast Flow Technology Engineering Co Ltd
捷流技术工程（广州）有限公司
Guangzhou (China Head Office) 捷流中国总办事处
1st Floor De Yue Building,
Hua Tai Hotel,
No 23, Xian Lie Nan Road
Yue Xiu District, Postal Code 510101,
Guangzhou
广州市越秀区先烈南路23号,
华泰宾馆
得月楼首层, 邮编510101
T: +86 20 8762 0868
F: +86 20 8774 5090

Fast Flow (Thailand) Co. Ltd
Nutri Building, 3rd Floor,
46 Soi Pattanakarn, 20
Suan Luang Bangkok
Thailand 10250
T: +66 2 369 3240-4
F: +66 2 369 3245

Fast Flow Malaysia Sdn Bhd
No. 39, Jalan Pendidik U1/31,
Hicom Glenmarie Industrial Park Phase 1B,
Seksyen U1, 40150 Shah Alam, Selangor Darul
Ehsan
Kuala Lumpur
T: +60 3 5569 1807/ 1821
F: +60 3 5569 1707

Fast Flow Singapore Pte Ltd
No 1 Fifth Avenue, #04-04 Guthrie House
Singapore 268802
T: +65 65004650
F: +65 6500 4665

Above information does not include the addresses of our licensed distributors, please contact us at communications@fastflowgroup.com for further information regarding our distributors in Indonesia, Taiwan and Turkey.